



## 110 Wyndham Road, Salisbury, Wiltshire, SP1 3AQ

An attractive character two bedroom terraced house conveniently situated close to the city centre within a no-through road.

- TWO BEDROOMS
- TWO RECEPTION ROOMS
- KITCHEN WITH COOKER
- GAS CENTRAL HEATING
- CITY CENTRE LOCATION
- REAR GARDEN
- DOUBLE GLAZED
- PERIOD FEATURES

**£975 PCM**

## Ground Floor

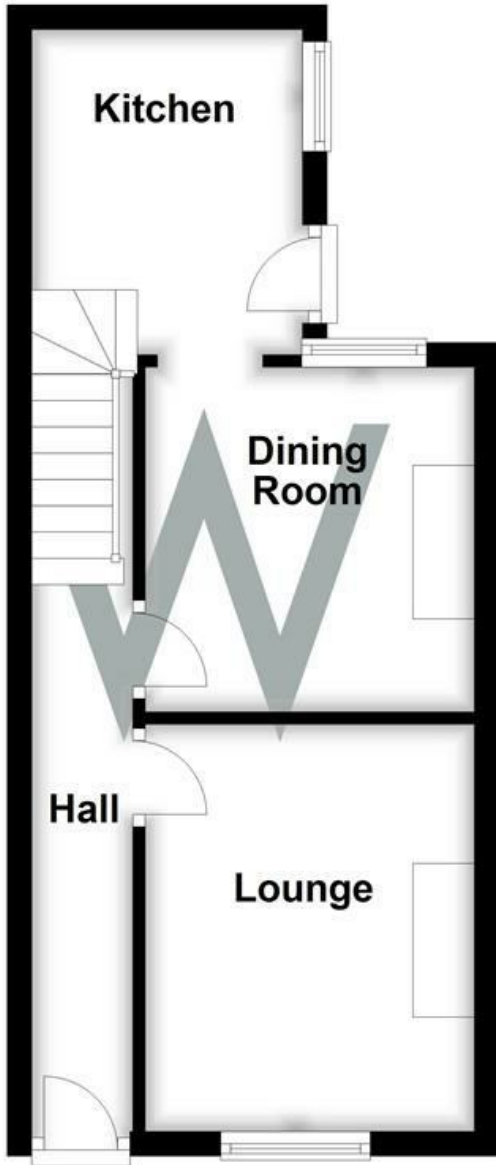

## First Floor

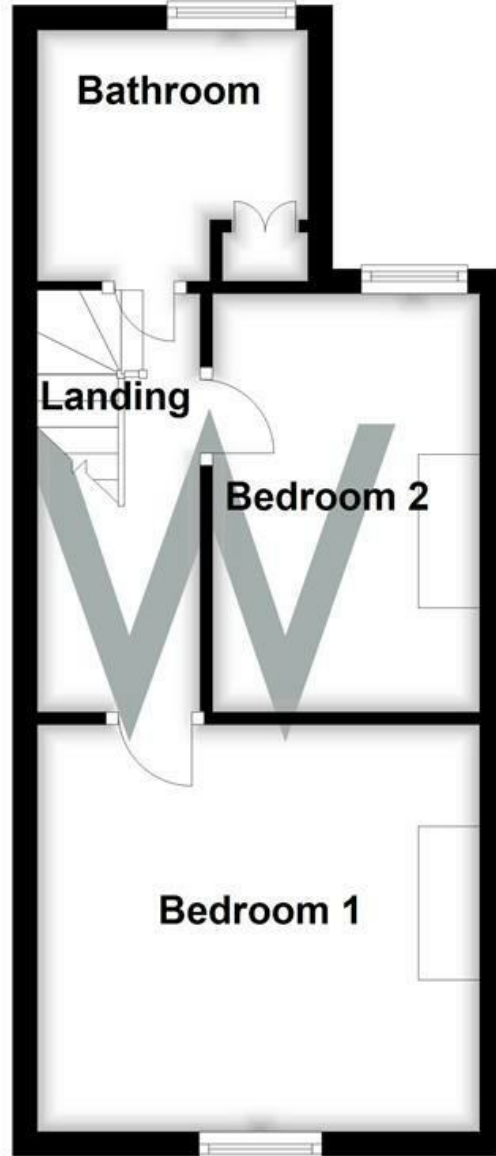

### WHITES

Castle Chambers, 47 Castle Street, Salisbury,  
Wiltshire, SP1 3SP  
Tel: 01722 336422/Option 2  
www.hwwhite.co.uk  
email: lettings-management@hwwhites.co.uk

Energy Efficiency Rating		Current	Potential
Very energy efficient - lower running costs			
(92 plus) A			87
(81-91) B			
(69-80) C			
(55-68) D		68	
(39-54) E			
(21-38) F			
(1-20) G			
Not energy efficient - higher running costs			
England & Wales		EU Directive 2002/91/EC	

Environmental Impact (CO <sub>2</sub> ) Rating		Current	Potential
Very environmentally friendly - lower CO <sub>2</sub> emissions			
(92 plus) A			
(81-91) B			
(69-80) C			
(55-68) D			
(39-54) E			
(21-38) F			
(1-20) G			
Not environmentally friendly - higher CO <sub>2</sub> emissions			
England & Wales		EU Directive 2002/91/EC	